

HYDRO

Capacity range 1500 - 8000 Kg

**Goods/
Passenger lifts
GPL 25, GPL 40
GPL 40F, GPL 80F**

Modular design which fulfils customers requirements

Lift designed for Forklift loading

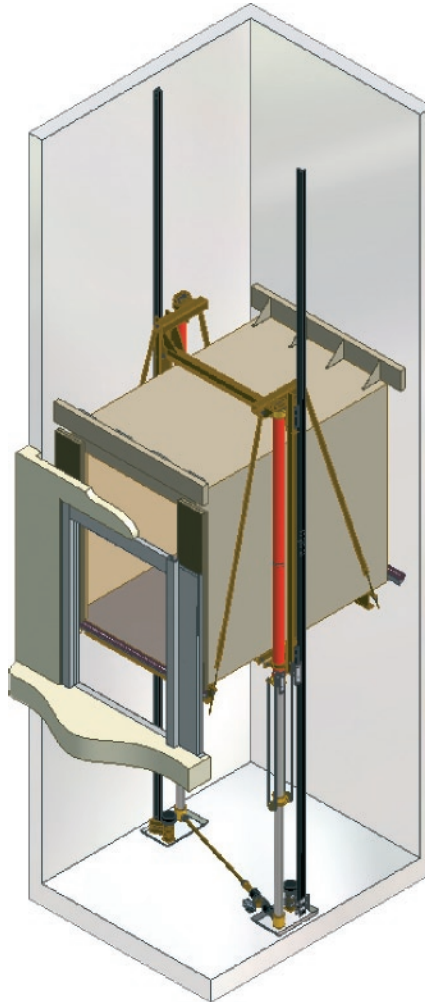

RELIABLE IN SERVICIE

- Robust and durable car design.
- Door sills designed for Forklift truck loading.

SAFE

- Type approved according to Lift Directive 95/16/EC
- Tank unit and controller are placed in a service friendly machine room
- Automatic return to landing in case of power failure (option)

FLEXIBLE

- Modular design which fulfils different customers requirements regarding rated load and car dimensions
- The car frame and jack design result in minimum shaft dimensions in relation to the car size

COST EFFECTIVE

- Components prepared for a quick and easy installation
- Low service and maintenance cost due to well known standard GMV components



GMV Sweden AB
Forsdalavägen 1,
Box 19
342 21 Alvesta
Tel.: +46 472 45600
Fax: +46 472 45699
www.gmv.se
e-mail: info@gmv.se



No.1 in the world
with more than 650.000
hydraulic lift
components installed

ADVANTAGES WITH DIRECT ACTING JACK 1:1 COMPARED TO ROPED HYDRAULIC IN 2:1 SOLUTION

- Higher stability during loading and unloading the car due to no rope elongation.
- No safety gear, safety gear contact, ropes or pulley needed.
- Simple to install and reduced service requirements.
- Reduced size of guide rail due to lower buckling force as no safety gear is used.
- Tubing system is designed with 1 rupture valve for a safe and reliable function.
- Lower weight reduces jack and pump/motor size.



Chequered RAL 7004



Bumpers



Lighting

GPL CAR SPECIFICATION

Size:	Width 1200-3200 mm Deep Upp to 6000 mm Height 2200-2600 mm
Floor	Chequered plate RAL-colour 7004
Walls	Galvanized steel
Celing	Galvanized steel painted white
Bumpers	Solid hard wood at two levels
Sill	Solid steel for forklift modell (F) and reinforced aluminium
Lighting	Flush mounted fluorescent lights.

CAR OPTIONS

Sill	Inox
Walls	Inox, RAL-colour 1015, 7030, 7035
Celing	Inox
Floor	Aluminium 5 bar or steelplate
Celing	Emergency trap door



RAL 1015



RAL 7030



RAL 7035



Aluminium FIVE BAR

DOOR SPECIFICATION

Size	Width up to 3200 mm Height up to 2500 mm
Operator	VVVF controlled
Finishing	Epoxi RAL 7010
Sill	Solid steel for forklift modell (F) and reinforced aluminium for other
Panels	4 or 6 central opening reinforced aluminium for ther
Protection	Light curtain.



RAL 7010

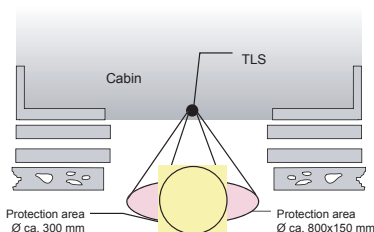

DOOR OPTIONS

Finishing	Stainless Steel
Sill	Solid steel or solid stainless steel
Protection	3D Monitoring system
Fire rating	According to local requirements.

USING WELL PROVEN COMPONENTS

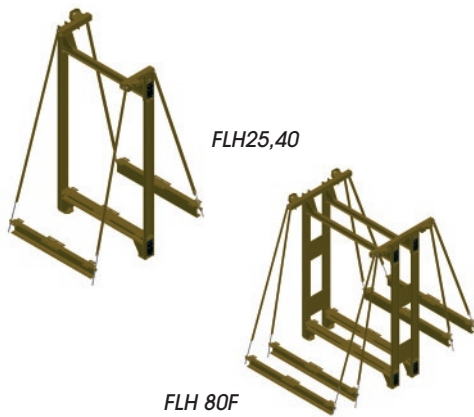

Carframe FLH and Guide rail

- Strong and light design for quick installation.
- Carframe design require a minimum shaft dimension in relation to car size.
- Rams always fixed close to the well, even with narrow car
- Guide rail machined in size T90, T125 or T127.

Jack EC or 1008

- Telescopic jacks are mechanical synchronized by chains, which gives a constant synchronization that do not need to be "resynchronized".
- Jack design maintains a minimum shaft dimension in relation to car size.
- Direct acting jacks secure a high stability during loading and unloading.
- GMV Sweden has 35years of experience with complete freight lifts where mechanical synchronized jacks have been used.
- Design certificate Inspecta 06-GOT-CL-0043.



Jack EC



Jack 1008

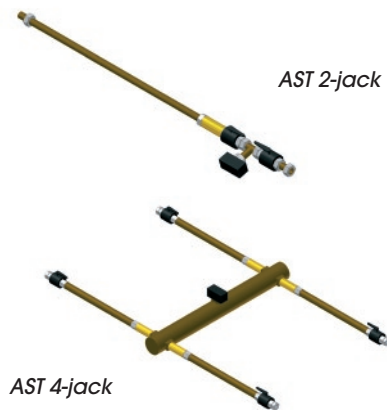

Tubing system AST

- The AST-tubing is a rigid pipe system with threaded connections. No welding on site is needed.
- The threaded connections with one adjustable part result in a quick and easy installation.
- Only one common rupture valve secure a safe and reliable function.
- Design certificate Inspecta 06-GOT-CL-0042.

Power unit

- Power unit designed for installation in service friendly machine room.
- Valve 3010 with soft stop as standard and electronic valve as option.
- Star/Delta start or soft starter is supplied.
- Auxiliary motor/pump for controlled re levelling and main motor start reduction.
- Flexible hose between power unit and rupture valve on AST-tubing.

Controller, telephone and Pushbuttons

- APB (direct control) or Pick up (memorized direct control).
- Complete pre wired electric installation to reduce installation time.
- Soft starter is supplied, as standard.
- Auxiliary motor control for re levelling, as option.
- Emergency telephone according to EN 81-28.
- Pushbuttons according to EN 81-70.

GPL 25 GPL 40 GPL 40F

Capacity range 1500 - 4000 Kg

**EC Type approved according
to Lift Directive 95/16/EC**

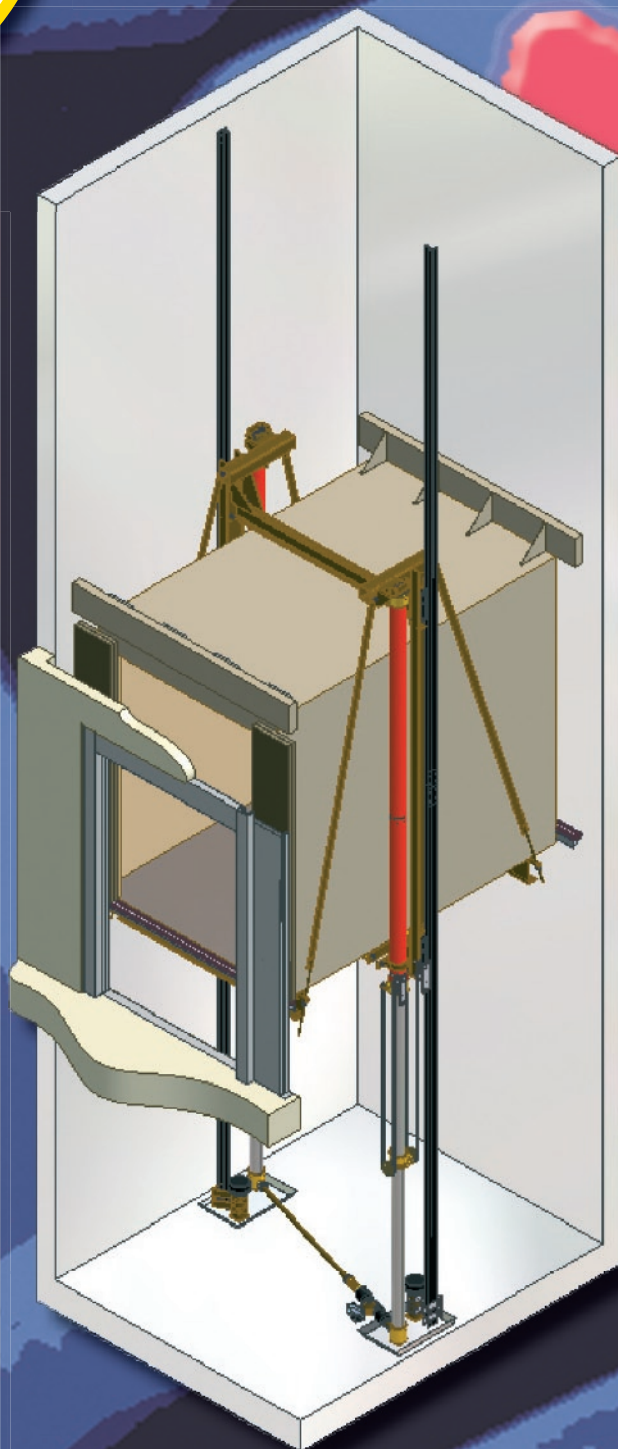

GPL 80F

Capacity range 4000 - 8000 Kg

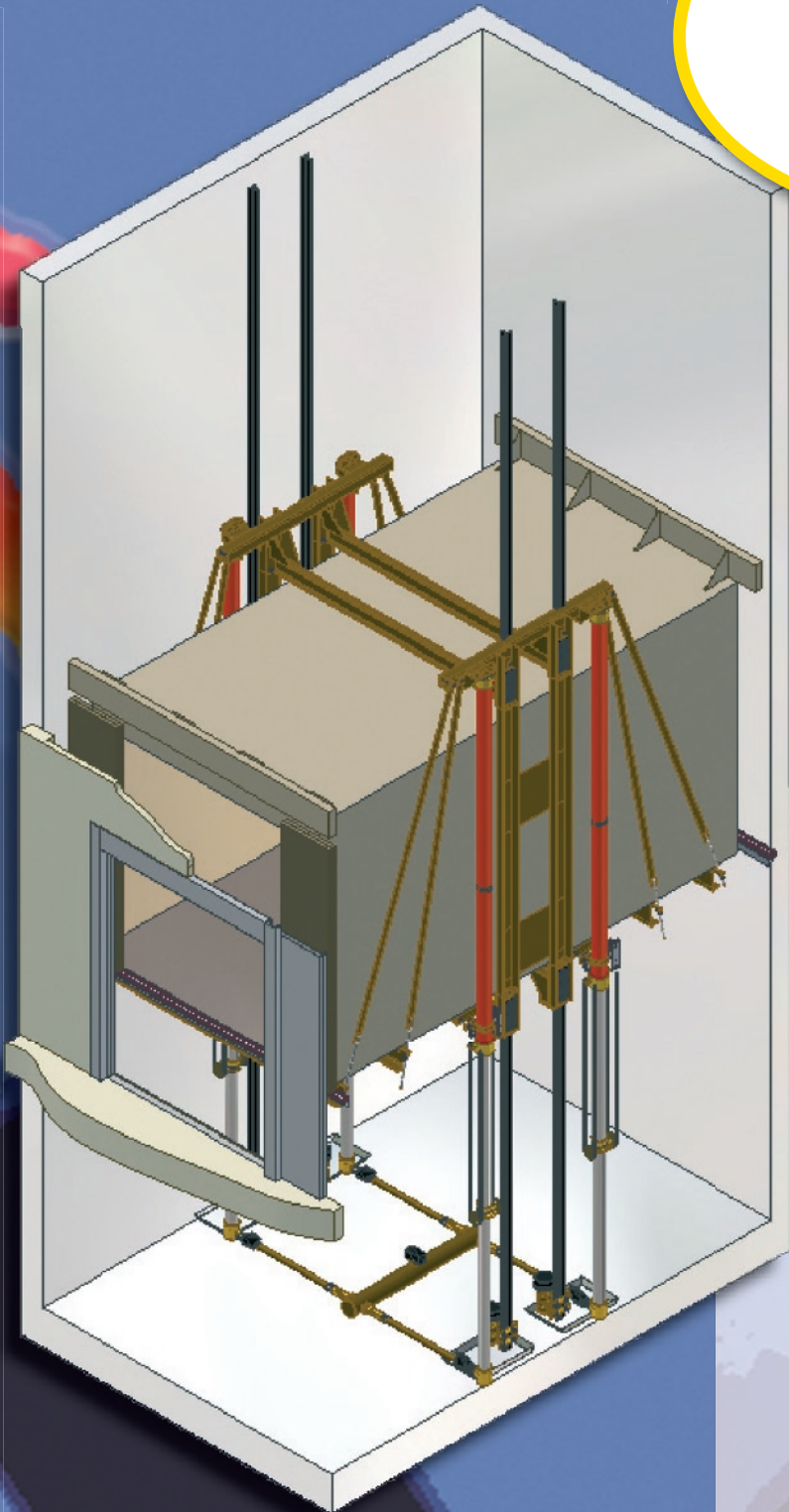

VL



HYDRO

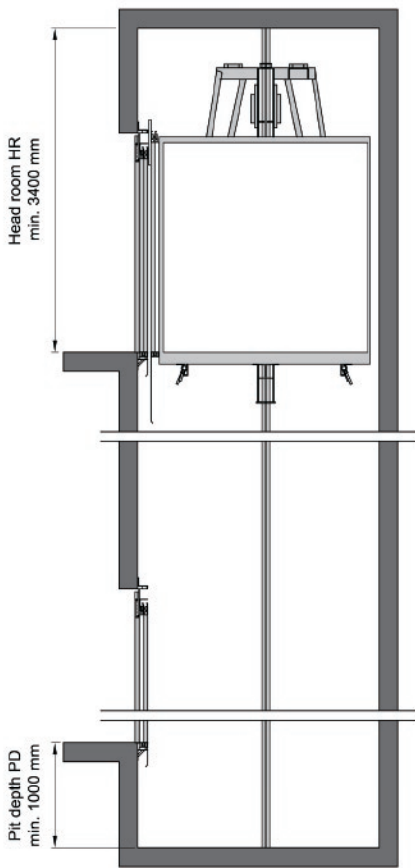

GPL 25, GPL 40, GPL 40F

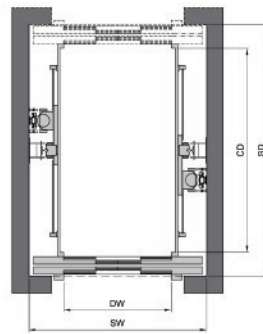

GPL 80F

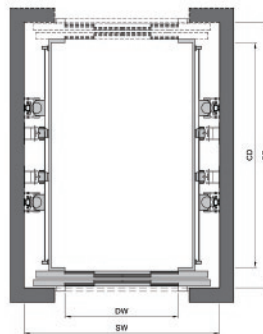

GPL 25
GPL 40
GPL 40F
GPL 80F

GPL 25, GPL 40, GPL 40F, GPL 80F, VL

F = Designed for forklift loading
VL = Vehicle Lift

Lift Type	Rated load kg	Car area m ²	Car width CW mm	Car depth CD mm	No. of Jacks	Car height CH mm	Shaft width SW mm	Door width DW mm	Shaft width SW min at 4- panel door	Shaft width SW min at 6- panel door	Door height DH mm
GPL 25	1500-2500	<4,85	1200-1700	1700-3950	2	2200-2600	CW + 700 to 1300	Optional DW = (CW-100) mm, max 3000 mm	1,5 x CW + 200 mm	1,35 x CW + 200 mm	2000 - 2500
GPL 40	2500-4000	<7,15	1700-2700	1700-4200	2						
GPL 40F	2500-4000	<7,04	1700-3200	1700-4100	2						
GPL 80F	4000-8000	<13,5	1700-2900	3000-6000	4						
VL	3800	13,44	2400	5600	2						
Max speed 0,63 m/sec											
Max car travel 20 m											



GMV Sweden AB
Forsdalavägen 1,
Box 19
342 21 Alvesta
Tel.: +46 472 45600
Fax: +46 472 45699
www.gmv.se
e-mail: info@gmv.se



GMV S.p.A. - Italy
Via Don Gnocchi, 10
20016 Pero (MI)
Tel.: + 39 02 33930.1
Fax: + 39 02 3390379
www.gmv.it